

DESCRIPTION

- Buse de pulvérisation carré à cône plein avec répartition uniforme des gouttelettes.
- Corps vertébral en X imperméable aux blocages
- Filetage mâle BSPT et NPT ou filetage femelle
- Matériaux : SS303 et SS316L
- Autres matériaux ou angles de pulvérisation sur demande
- Pression maximale : 70 bar



DONNÉES TECHNIQUES

Filetage extérieur BQM, BKF pour filetage intérieur

| TYPE | Filetage | | | | | | Débit (lpm) @ pression (Bar) | | | | | | | | Angle de pulvérisation (°) @ Pression (Bar) | | |
|------|----------|-------|------|------|------|----|------------------------------|-------|-------|-------|-------|-------|--------|--------|---------------------------------------------|-----|----|
| | 1/8 " | 1/4 " | 3/8" | 1/2" | 3/4" | 1" | 0.35 | 0.7 | 1 | 1.5 | 2 | 3 | 6 | 8 | 0.7 | 2 | 6 |
| 6 | ☑ | ☑ | - | - | - | - | 0.88 | 1.25 | 1.50 | 1.88 | 2.18 | 2.65 | 3.41 | 3.76 | 40 | 47 | 40 |
| 8 | ☑ | ☑ | - | - | - | - | 1.3 | 1.53 | 2.28 | 2.84 | 3.23 | 4.00 | 5.38 | 5.97 | 44 | 56 | 53 |
| 11 | ☑ | ☑ | - | - | - | - | 1.63 | 2.32 | 2.87 | 3.62 | 4.05 | 4.87 | 6.3 | 7.06 | 52 | 64 | 58 |
| 12 | ☑ | ☑ | ☑ | - | - | - | 2.09 | 2.79 | 3.41 | 4.09 | 4.55 | 5.3 | 7.02 | 8.01 | 62 | 70 | 58 |
| 16 | - | ☑ | ☑ | - | - | - | 2.50 | 3.58 | 4.41 | 5.30 | 6.14 | 7.27 | 9.51 | 10.61 | 62 | 70 | 58 |
| 20 | - | ☑ | ☑ | - | - | - | 3.11 | 4.46 | 5.46 | 6.5 | 7.54 | 9.06 | 11.92 | 13.43 | 62 | 73 | 58 |
| 22 | - | ☑ | ☑ | - | - | - | 3.58 | 5.11 | 6.24 | 7.51 | 8.32 | 9.78 | 13.23 | 14.95 | 70 | 80 | 62 |
| 27 | - | - | ☑ | ☑ | - | - | 4.23 | 6.04 | 7.42 | 9.01 | 10.10 | 12.32 | 16.06 | 18.08 | 70 | 80 | 62 |
| 32 | - | - | ☑ | ☑ | - | - | 5.81 | 7.25 | 8.88 | 10.81 | 12.32 | 14.44 | 19.29 | 22.12 | 70 | 80 | 62 |
| 42 | - | - | - | ☑ | - | - | 6.74 | 9.67 | 11.82 | 14.44 | 15.96 | 19.29 | 24.92 | 28.48 | 70 | 76 | 64 |
| 47 | - | - | - | ☑ | ☑ | - | 7.48 | 10.61 | 13.03 | 14.95 | 17.78 | 21.11 | 28.48 | 31.71 | 43 | 57 | 42 |
| 49 | - | - | - | ☑ | - | - | 8.17 | 11.62 | 14.24 | 16.36 | 18.69 | 23.13 | 29.29 | 33.94 | 79 | 86 | 72 |
| 63 | - | - | - | ☑ | ☑ | - | 10.20 | 14.44 | 17.07 | 20.5 | 23.84 | 28.89 | 38.48 | 43.94 | 60 | 69 | 53 |
| 73 | - | - | - | - | ☑ | ☑ | 11.92 | 16.26 | 20.00 | 22.62 | 27.78 | 34.24 | 45.65 | 52.02 | 35 | 41 | 44 |
| 77 | - | - | - | - | ☑ | ☑ | 12.32 | 17.68 | 20.50 | 23.94 | 29.09 | 34.95 | 45.65 | 52.02 | 70 | 73 | 60 |
| 89 | - | - | - | - | ☑ | ☑ | 13.94 | 20.00 | 23.74 | 29.39 | 33.63 | 40 | 52.92 | 59.29 | 82 | 85 | 67 |
| 102 | - | - | - | - | ☑ | ☑ | 14.85 | 20.91 | 27.37 | 33.73 | 38.68 | 46.26 | 60.10 | 67.87 | 85 | 97 | 74 |
| 105 | - | - | - | - | - | ☑ | 16.26 | 23.23 | 27.78 | 33.72 | 39.79 | 48.18 | 62.42 | 71.51 | 51 | 57 | 49 |
| 123 | - | - | - | - | - | ☑ | 19.49 | 28.38 | 34.64 | 42.32 | 46.56 | 57.77 | 75.95 | 85.55 | 66 | 73 | 57 |
| 140 | - | - | - | - | - | ☑ | 22.73 | 32.02 | 38.18 | 45.25 | 53.23 | 62.12 | 80.80 | 90.90 | 75 | 81 | 52 |
| 162 | - | - | - | - | - | ☑ | 25.55 | 36.26 | 44.64 | 53.03 | 61.41 | 72.22 | 95.14 | 108.07 | 74 | 86 | 63 |
| 193 | - | - | - | - | - | ☑ | 28.79 | 41.81 | 50.10 | 60.70 | 73.23 | 87.57 | 119.18 | 135.34 | 82 | 100 | 80 |

DIMENSIONS

| Jonction | | SW | L | LG |
|-----------------------|-----|------------------|------|----|
| | | (en millimètres) | | |
| Filetage mâle 1/8" | BQM | 11 | 17.5 | 7 |
| Filetage femelle 1/8" | BQF | 13 | 25 | 7 |
| Filetage mâle 1/4" | BQM | 14 | 22 | 10 |
| Filetage femelle 1/4" | BQF | 17 | 34 | 10 |
| Filetage mâle 3/8" | BQM | 17 | 25 | 10 |
| Filetage femelle 3/8" | BQF | 22 | 38 | 10 |
| Filetage mâle 1/2" | BQM | 22 | 32 | 13 |
| Filetage femelle 1/2" | BQF | 25 | 45 | 13 |
| Filetage mâle 3/4" | BQM | 27 | 38 | 15 |
| Filetage femelle 3/4" | BQF | 30 | 55 | 15 |
| Filetage mâle 1" | BQM | 36 | 50 | 17 |
| Filetage femelle 1" | BQF | 36 | 70 | 17 |

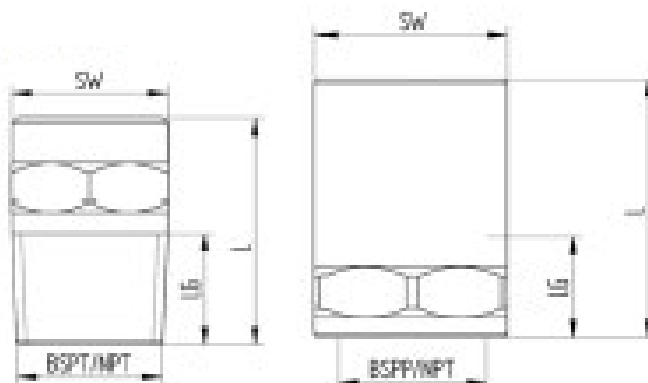

COMMENT COMMANDER

Filetage BQM (extérieur) / BQF (intérieur) type matériau
3/4" BQM 77 SS303