

DESCRIPTION

The CL7 nozzle produces a solid cone type spray pattern from a multiple orifice body. The cluster consists of a body fitted with 7 removable solid cone spray nozzles. It provides relatively uniform distribution at all pressures and a 270° spray pattern. Flat, sharply defined spray pattern with high impact force

- Available with 3/4" - 2" BSPP
- Female threads only
- Different spray nozzles can be installed to give non-standard spray patterns for targeted cleaning
- Made in Brass and Stainless Steel as standard
- Other materials available to special order

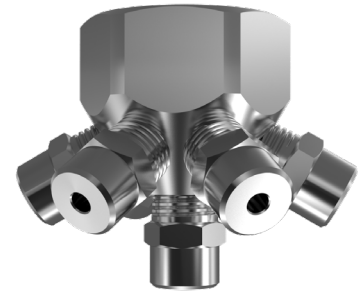

TECHNICAL DATA

TYPE	Nozzles	Thread					Flow rate (lpm) @ pressure (Bar)								
		3/4"	1"	1 1/4"	1 1/2"	2"	0,7	1,0	2,0	3,0	4,0	5,0	6,0	7,0	
CL7-50	1/8" BIM 6	☑	☑	☑	-	-	8,75	10,50	15,26	18,55	20,09	22,46	23,87	24,78	
CL7-75	1/8" BIM 8	☑	☑	☑	-	-	13,02	15,96	22,61	28,00	31,85	35,60	37,66	40,04	
CL7-100	1/4" BIM 12	☑	☑	☑	☑	☑	19,53	23,87	31,85	37,10	41,37	46,25	49,14	53,06	
CL7-135	1/4" BIM 16	☑	☑	☑	☑	☑	25,06	30,87	42,98	50,89	56,00	62,61	66,57	70,28	
CL7-160	1/4" BIM 20	☑	☑	☑	☑	☑	31,22	38,22	52,78	63,42	70,00	78,26	83,44	88,41	
CL7-200	1/4" BIM 25	☑	☑	☑	☑	☑	39,03	47,78	65,98	79,28	87,50	97,83	104,3	110,5	
CL7-250	3/8" BIM 32	-	☑	☑	☑	☑	50,57	62,16	86,24	101,9	111,7	124,9	135,0	140,3	
CL7-300	3/8" BIM 37	-	☑	☑	☑	☑	58,67	71,86	99,69	117,3	129,1	144,3	156,0	162,2	
CL7-350	1/2" BIM 42	-	-	☑	☑	☑	67,69	82,74	111,7	135,0	150,0	167,7	174,6	191,6	
CL7-400	1/2" BIM 49	-	-	☑	☑	☑	81,34	99,68	130,8	161,9	175,3	196,0	205,0	227,6	
CL7-500	1/2" BIM 63	-	-	-	☑	☑	101,1	119,5	166,9	202,2	225,5	252,1	269,4	289,1	
CL7-600	1/2" BIM 77	-	-	-	☑	☑	113,2	135,4	191,4	234,4	270,6	302,6	331,4	325,4	
CL7-700	3/4" BIM 89	-	-	-	-	☑	140,0	166,2	235,4	280,0	311,8	338,0	370,4	393,8	
CL7-825	3/4" BIM 102	-	-	-	-	☑	146,4	171,6	270,8	323,8	350,0	384,0	420,7	451,8	

Maximum Recommended Pressure: 35 Bar.G.

DIMENSIONS

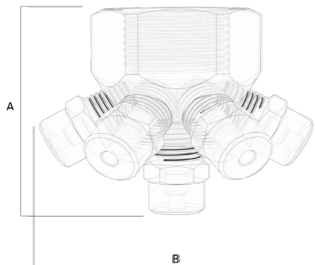

Thread	DIMENSIONS & WEIGHT		
	A	B Dia	Weight
	mm		Kg
3/4"	43,25	59,0	0,33
1"	55,00	67,5	0,66
1 1/4"	80,00	100,0	1,63
1 1/2"	80,00	110,0	1,66
2"	90,00	130,0	2,10

HOW TO ORDER

Thread CL7-type material

1 1/2" CL7-500 SS